



More information on the website
mirror.radwag.com/en/info,w1,CB2

SDKP Workstation for Pipettes Calibration

WL-101-0181



The drawings, photos and graphics used are for illustrative purposes only.

Datasheet

Physical parameters	
Delivery components	table for calibration, anti-vibration table, probe for temperature, humidity and pressure measurement, probe for water temperature measurement, sink for used water, armrests, LCD monitor, PC with pre-installed software PIPETTES RADWAG, power supply, keyboard and mouse, container for used water
Packaging dimensions W x D x H	820×1160×890 mm
Length	1100 mm
Width	750 mm
Height	1100 mm
Number of workstations	1

Compatible with (Additional Fee)

XA 5Y.M.A.P Microbalance for pipettes calibration
 MYA 5Y.P Microbalance for pipettes calibration
 AS X7 Analytical Balance
 Pipette Tips

AS 5Y Analytical Balance
 AS R2 PLUS Analytical Balance
 AS R1 PLUS Analytical Balance
 THBR 2.0 System - Ambient Conditions Monitoring

Device dimensions W x D x H

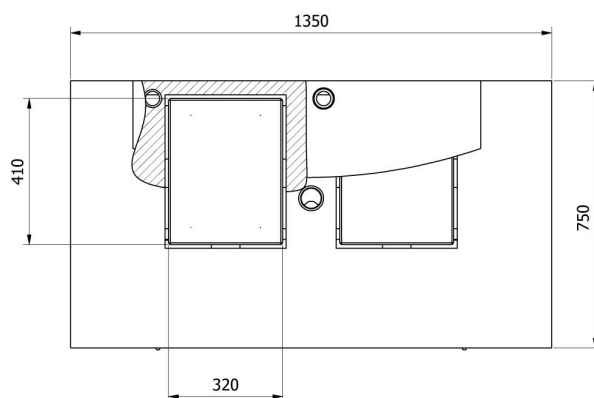
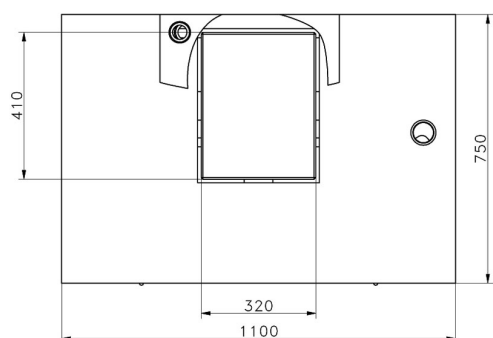
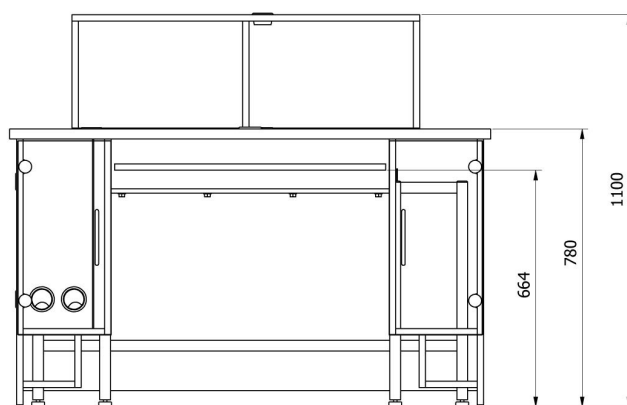
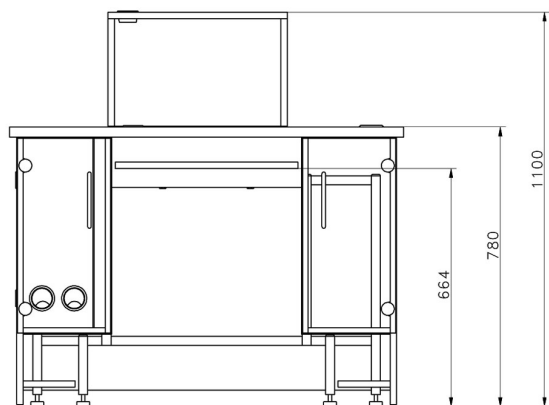

—SDKP

—SDKP DUAL